



International Boundary and Water Commission United States Section

For immediate release
September 25, 2023

UPPER VALLEY LEVEE REHABILITATION IN EL PASO: TEMPORARY TRAFFIC CHANGES AT COUNTRY CLUB ROAD BRIDGE CROSSING RIO GRANDE

The United States Section of the International Boundary and Water Commission (USIBWC) is temporarily shifting two-lane traffic in El Paso, Texas, along the Country Club Road Bridge that crosses the Rio Grande due to construction of new floodgate systems at the bridge as part of the ongoing rehabilitation of the flood control levee from Borderland Road to Racetrack Drive.

The construction for new stoplog systems on both ends of the Country Club Road Bridge requires demolition, removal of the existing east side floodgate, and reconstruction of pavement. The work will be phased to allow the bridge to remain open to vehicular and pedestrian traffic during construction. The current construction schedule indicates traffic will be shifted starting Monday, October 2, 2023, but is subject to change. The total traffic change period will be approximately five months.

Traffic lanes and pedestrian access will be shifted north under Phase 1 for approximately nine weeks between October 2 through December 2 to allow construction along the south side. Under Phase 2, the vehicular traffic lanes will remain unchanged, but the pedestrian traffic will shift south for approximately five weeks between December 3 through January 6, 2024, to allow for work to take place in the center of the bridge. The final Phase 3 will shift the vehicular traffic south next to the pedestrian access for approximately seven weeks between January 7

through February 24, 2024, while work is completed on the north side. The maps below illustrate the traffic changes during each phase.



Phase 1: All Traffic Shifted North



Phase 2: Vehicular Traffic Remains at North and Pedestrian Access Shifted South

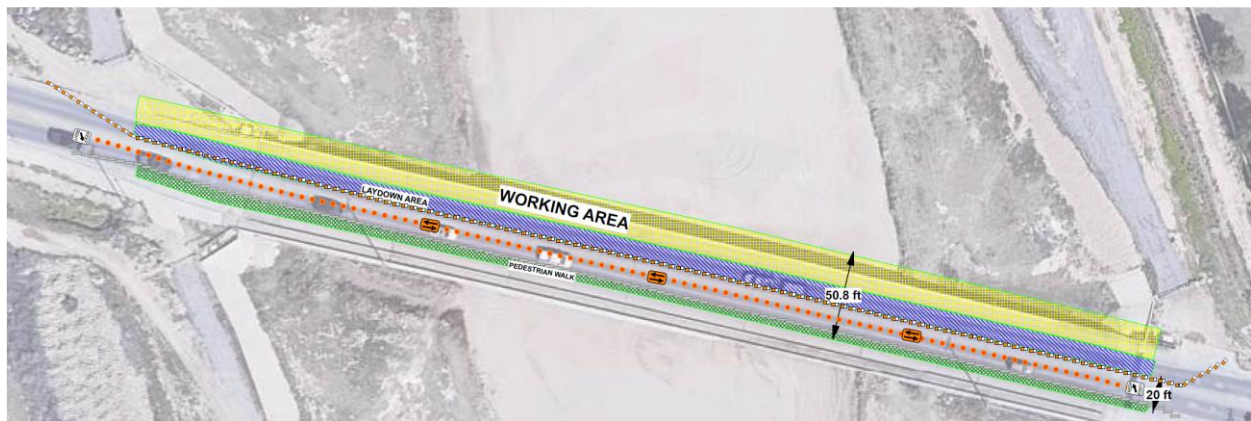

Phase 3: All Traffic Shifted South

The levee rehabilitation project extends approximately 0.6 miles along the west levee of the Rio Grande from Country Club Road to the Nemexas Drain and approximately 8.4 miles along the east levee of the Rio Grande from upstream Borderland Road to downstream of

Racetrack Drive. USIBWC contractors are placing impervious clay on the levee and a deployable stoplog system at the Country Club Road bridge to improve flood protection.

Construction for the whole project should be completed by March 2025.

For more information:

Frank Fisher, Public Affairs Chief
(915) 494-6027
frank.fisher@ibwc.gov