



## **International Boundary and Water Commission United States Section**

For immediate release  
December 13, 2023

### **UPPER VALLEY LEVEE REHABILITATION IN EL PASO: UPCOMING FINAL TRAFFIC CHANGES AT COUNTRY CLUB ROAD BRIDGE CROSSING RIO GRANDE**

The United States Section of the International Boundary and Water Commission (USIBWC) is scheduled next month to complete the final temporary shift of two-lane traffic in El Paso, Texas, along the Country Club Road Bridge that crosses the Rio Grande for the last construction phase of the new floodgate systems at the bridge. These new systems are part of the ongoing rehabilitation of the flood control levee from Borderland Road to Racetrack Drive.

The construction for new stoplog, or hydraulic engineering control system, on both ends of the Country Club Bridge requires demolition, removal of the existing east side floodgate, and reconstruction of pavement. As the public has been aware, the construction for these new stoplog systems on both ends of the Country Club Bridge has been ongoing since October 2023, and the work will be transition to the final phase of construction and traffic control during the week of January 8, 2024. The traffic control setup allows for the bridge to remain open to vehicular and pedestrian traffic during construction. The work and traffic shift are scheduled to be completed by February 29, 2024.

The traffic lanes will be shifted from the current route under Phase 2 along the north side of the Country Club bridge to the south side next to the pedestrian access for the final Phase 3 so that work may be completed on the north side of the bridge. The images below illustrate the traffic patterns during each phase.



Phase 2: Current Temporary Traffic Lanes at North

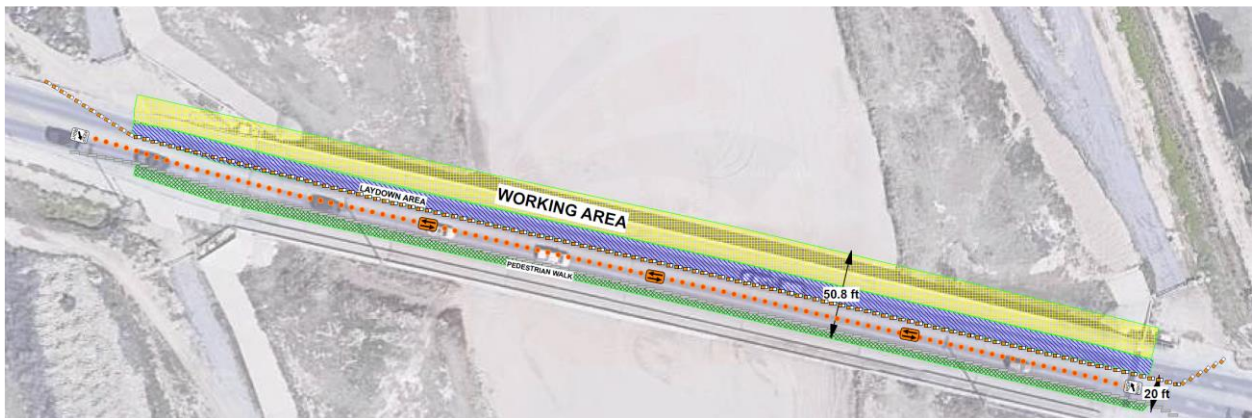

Phase 3: All Traffic Shifted to South of Bridge the Week of 1/8/24

The levee rehabilitation project extends approximately 0.6 miles along the west levee of the Rio Grande from Country Club Road to the Nemexas Drain and approximately 8.4 miles along the east levee of the Rio Grande from upstream Borderland Road to downstream of Racetrack Drive. USIBWC contractors are placing impervious clay on the levee and a deployable stoplog system at the Country Club Road bridge to improve flood protection.

Construction for the whole project should be completed by March 2025.

For more information:

Frank Fisher, Public Affairs Chief  
(915) 494-6027  
[frank.fisher@ibwc.gov](mailto:frank.fisher@ibwc.gov)